

Mountain Bear Lodge - Nethybridge
 Visit Scotland - "5 Star"
 A stunning Canadian log house constructed from Mammoth logs, set in woodland. large lounge with log stove, fabulous kitchen, 6 bedrooms, 3 doubles, 2 bunk and 1 twin (4 en-suite), luxury spa suite with Sauna and Double Jacuzzi, Outside hot tub, large deck & all weather BBQ hut, Wi-Fi.
 Can sleep up to 16 people.

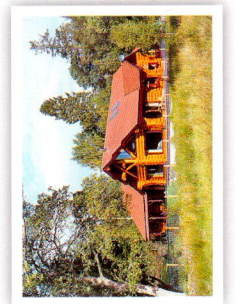

Birchwood Lodge - Kintraig
 Visit Scotland - "5 star"
 A fantastic luxury, contemporary, newly constructed lodge in a woodland setting with mountain views. 5 bedrooms, 3 kingsize, 1 twin all en-suite, 1 family room with 4 single beds, family bathroom, fantastic kitchen and dining area, lounge, snug, log stove, hot-tub, Wi-Fi, BBQ.
 Sleeps 12.



The Shieling - Aviemore
 This tards like country house, set in an elevated garden overlooking Aviemore has 5 bedrooms, 1 family room, 2 twins, 2 doubles, 4 bathrooms (2 en-suite), large kitchen, utility room, lounge with log stove, conservatory, dining area, Wi-Fi, patio & BBQ with outside hot-tub.
 Sleeps 12.



Rowan Cottage - Avielochan - Aviemore
 An idyllic loch side cottage with stunning views to the Cairngorms. 2 Double Bedrooms, 1 Family Bedroom, 1 Twin, (2 en-suite) and 1 family bathroom, open fire. Shower-room, lounge and dining room, conservatory, kitchen, BBQ area, Wi-Fi and hot-tub.
 Sleeps 10.

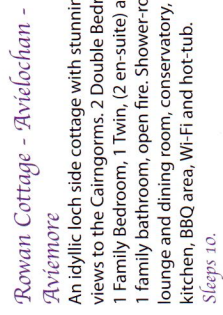

Burnside House - Aviemore
 Contemporary, newly built house in a private development on the outskirts of Aviemore.
 3 Bedrooms, 1 Kingsize en-suite, 1 double, 1 twin and double sofa bed in lounge, family bathroom and separate WC. Dog run outside, BBQ, Hot-Tub and Wi-Fi.
 Sleeps 6+2.

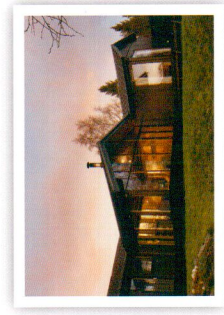

Ptarmigan Lodge - Nethybridge
 This American style ski lodge with river views has 4 bedrooms, 2 double, 1 twin and 1 bunk, plus a fold down bed in the "snug". There are 2 bathrooms (1 en-suite) + separate WC, a large open plan living space with log stove, luxury kitchen and dining area, large deck with outside hot-tub. Wi-Fi, BBQ.
 Sleeps 8 + 2.

Spey Cottage - Aviemore
 This charming late Victorian Cottage with stunning views of the river Spey and Cairngorm Mountains, easy walk into Aviemore. 4 bedrooms, 1 main bathroom, 1 shower room, country kitchen, lounge, large deck area, BBQ, log stove Wi-Fi.
 Sleeps 8.

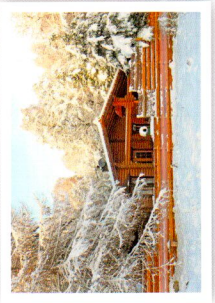

Red Squirrel Lodge - Boat of Garten
 This luxury lodge is set in a semi-rural location in the picturesque highland village of Boat of Garten. 3 bedrooms (3 en-suite), WC. Open plan kitchen/lounge, dining area, log stove, Wi-Fi, outdoor hot-tub, south-facing deck and BBQ.
 Sleeps 6+2.

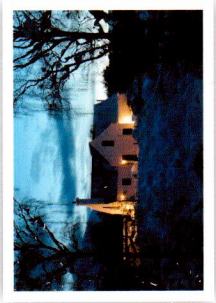

Osprey Lodge - Tulloch - Boat of Garten
 This is an architect designed lodge, set within the R.S.P.B. Nature Reserve close to Loch Garten. This outstanding luxury lodge has 3 bedrooms, 2 bathrooms, large lounge with wall bed, spacious kitchen, sun room, outside decks, BBQ, outside hot-tub, Wi-Fi.
 Sleeps 6+2.

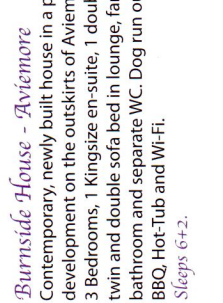

Pine Ridge Lodge - Boat of Garten
 Village location on a wooded ridge with forest and mountain views. With 4 bedrooms, 2 double both with en-suite, 1 twin and 1 bunk room with family bathroom. Lounge with log stove, contemporary kitchen, dining area. Wi-Fi, BBQ and Hot-tub.
 Sleeps 8.

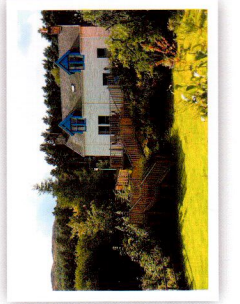

Beaver Creek Lodge - Aviemore
 Visit Scotland - "5 star"
 Scandinavian Log House with 3 bedrooms, 1 double, 1 twin and 1 bunk 2 bathrooms (1 en-suite), luxuriously appointed large lounge with log stove, outside hot tub on large deck, sauna suite with Jacuzzi. Fully equipped kitchen, Wi-Fi, BBQ.
 Sleeps 6+2.

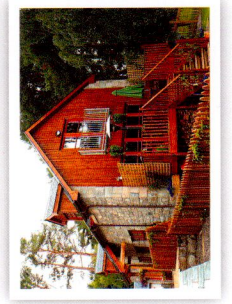

Wolf Lodge - Carrbridge
 Visit Scotland - "4 Star"
 Scandinavian A-Frame compact and cosy lodge. 2 bedrooms, 1 double and 1 bunk, plus a fold down bed in the lounge, well equipped with log stove and 1 shower room with sauna. Deck area, BBQ, Hot tub, Wi-Fi.
 Sleeps 4.

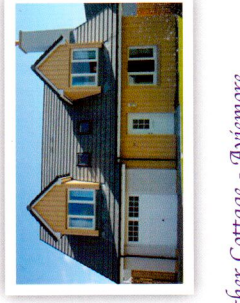

Eagle Lodge - Aviemore
 Located in a quiet residential area at the north end of Aviemore village, a comfortable, newly constructed detached Lodge. 1 kingsize bedroom, 1 double bedroom, 2 twin bedrooms. 3 bathrooms (1 en suite), lounge, kitchen and dining room. BBQ area, Wi-Fi.
 Sleeps 8.

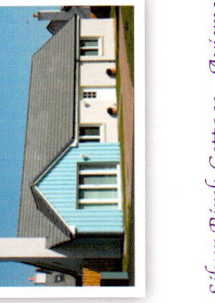

Silver Birch Cottage - Aviemore
 Located in a quiet cul-de-sac (close to Strathspey Steam Railway), semi-detached, 2 bedrooms, 1 double and 1 twin, 2 bathrooms (1 en-suite) with fold down bed in lounge. A many luxury touches including log stove. A small sauna. Mountain views.
 Sleeps 4+2.



Rat's Magic Cottage
 A traditional end terrace cottage built in 1905. Situated near the centre of Aviemore. 3 bedrooms, 1 bunk and 2 double. Bathroom & separate WC. Charming cottage with open fire and fabulous new kitchen with many personal touches. Wi-Fi.
 Sleeps 6.

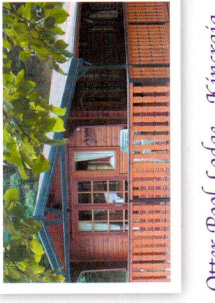

Two Hoofs Lodge - Aviemore
 A small cosy, comfortable budget cabin with veranda situated in a wooded glade. Easy walking distance to Aviemore. 1 double bedroom, 1 bunk room with two bunks. Shower room.
 Sleeps 4.

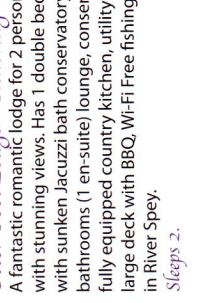

Otter Pool Lodge - Kintraig
 A fantastic romantic lodge for 2 persons with stunning views. Has 1 double bedroom with sunken Jacuzzi bath conservatory, 2 bathrooms (1 en-suite) lounge, conservatory, fully equipped country kitchen, utility room, large deck with BBQ, Wi-Fi Free fishing, 1 Rod in River Spey.
 Sleeps 2.

Heather Cottage - Aviemore
 Visit Scotland - "4 Star"
 Located in a quiet residential area at the north end of Aviemore village, the newly constructed detached lodge has 1 double bedroom (en suite) 1 twin, 1 bunk room (2 bunks), family bathroom, kitchen/dining room, lounge. Family membership of leisure Complex, BBQ area.
 Sleeps 6.